



*Portable  
Oxygen  
Concentrator*

# *Kingon P2*

*Breathe Free, Walk With You*



***Portable  
Oxygen Concentrator***

ISO



*Lightweight @ 1.98kg*

*NO Heavy Tanks*

*NO heavy Carts*

***Product***  
*Features*

01

## Lightweight

*1.98kg/4.37pouuds,1L-Oxygen concentrator in the world.*



1.98KKG



02

## Mini Size

*221\*85\*160mm, Very small size, easy to carry.*



03

## 5 Setting Flows

*From 1-5 setting flows, can meet different oxygen demand.*



1 setting flow  
**210ml/min**

2 setting flow  
**420ml/min**

3 setting flow  
**630ml/min**

4 setting flow  
**840ml/min**

5 setting flow  
**1000ml/min**

# 04

## Pulse Oxygen Supply

Kingon p2 is equivalent to 5 liters

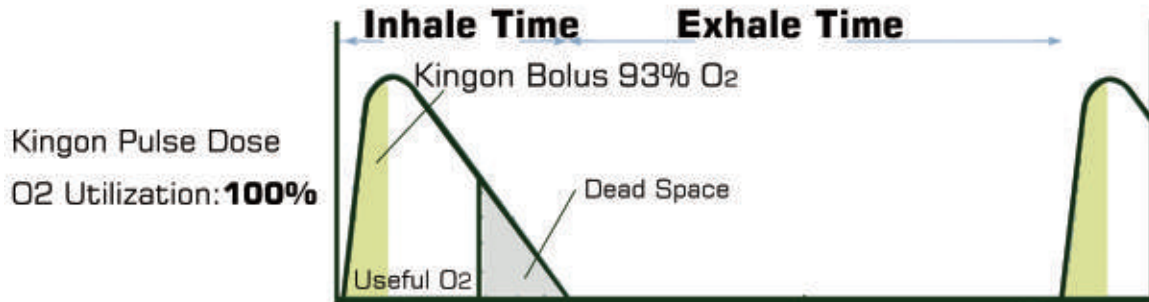

### Continuous *VS.* Pulse Flow

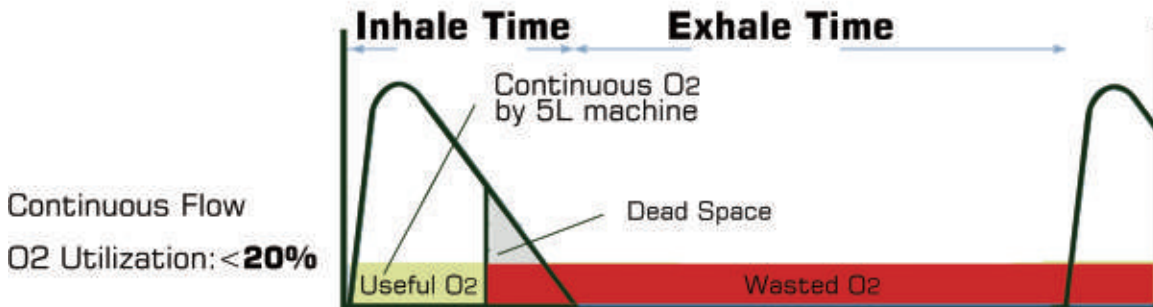



*Pulse Dose is based on breathing and inhaling, which is more sophisticated.*

*Pulse Dose mechanisms are more sensitive, utilizing an oxygen conserver and other technology to deliver oxygen based on breathing rates and other factors.*

*Kingon P2 is with a 0.097 cmH<sub>2</sub>O Trigger sensitivity, which is the most dependable and Sensitive portable oxygen concentrator in the world.*

*Continuous Flow is delivered at a constant rate indiscriminate of the user's breathing. you can see from the figure that , only 1/6 oxygen can be effectively exchanged on the lung during a Inhale-exhale cycle ,the rest 5/6 oxygen will be wasted in the respiratory tract and exhaling time.*

	<b>Pulse Dose</b>	<b>Continuous flow</b>
<b>Deliver oxygen</b>	<i>Based on breathing and inhaling</i>	<i>Constantly</i>
<b>Oxygen utilization rate</b>	100%	<20%
<b>Irritation to nose</b>	Less	More

05

## High Efficiency Molecular Sieve

*Efficient adsorption capacity, can purify more pure oxygen*

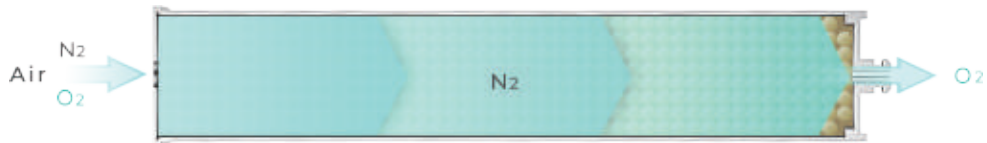

06

## ***Powerful Compressor***

*Powerful compressor can provide stable output*

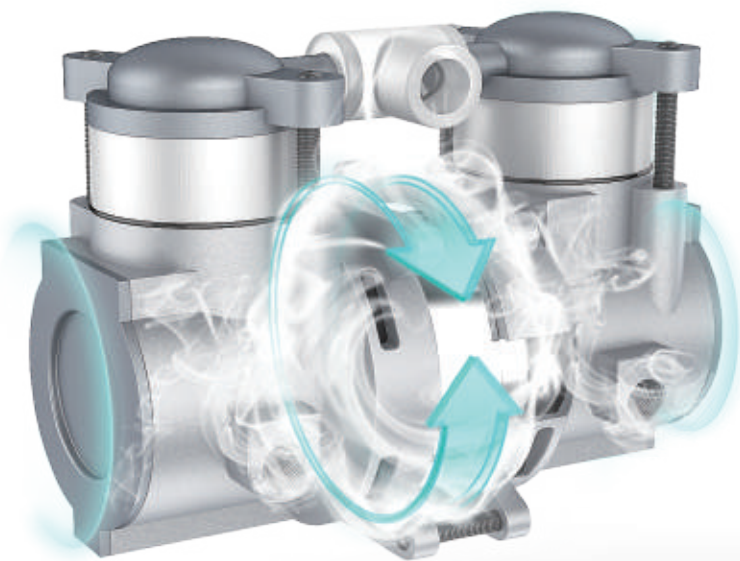

*High Efficiency*



*Low Noise*



*Excellent Heat Dissipation*



*Long Life*

# 07

## Triple Filtration

Effectively remove air pollen, large particles, dust and other impurities



Dust



Hair



Pollen



Granule

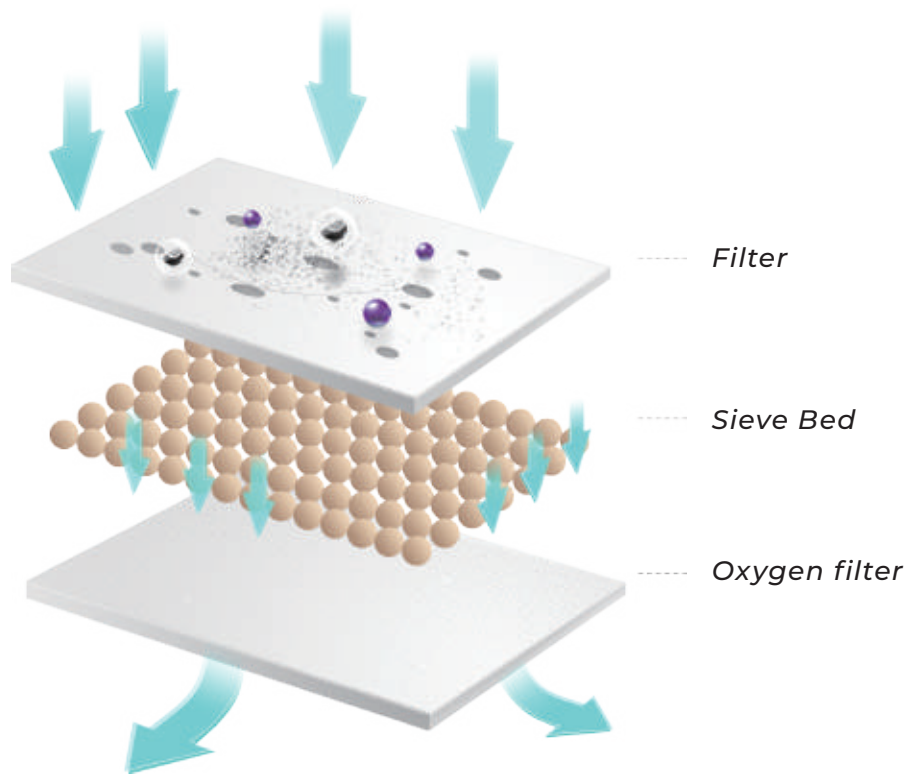

***BATTERY***

*Introduction*

# ***Battery***

*8 cell standard Battery Up to 5 hours  
Run Time Included with System.*

***Model  
# BA-P200***



Flow Setting 1  
5 h 00 min

---

Flow Setting 2  
3 h 50 min

---

Flow Setting 3  
3 h 00 min

---

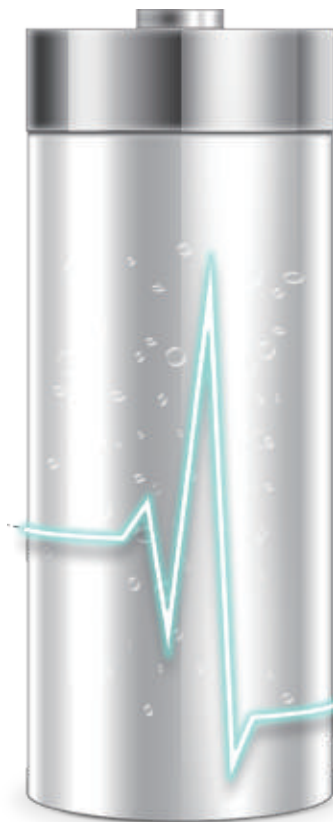

Flow Setting 4  
2 h 00 min

---

Flow Setting 5  
1 h 40 min

---

*\*The data may vary in different environment*

# ***External Battery Charger***

*when the battery is set correctly ,  
a solid red LED will indicate that the  
battery is charging.*

*when the green light illuminated,  
the battery is fully charged*

***Model # BC-P200***





***Product***  
*Diagram*

# 01 *Parts diagram*

24 types Alerts, Designed for 24/7 use

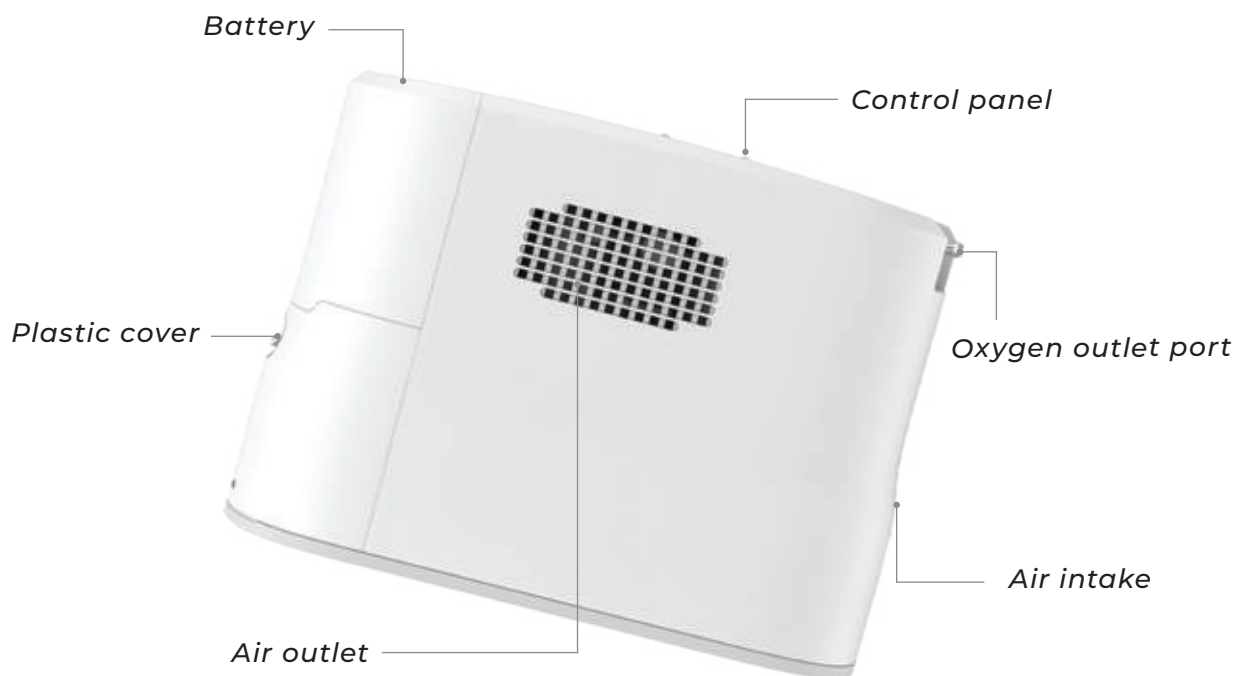

# Panel diagram 02

2.8 inch large color displayscreen ,Easy to read.

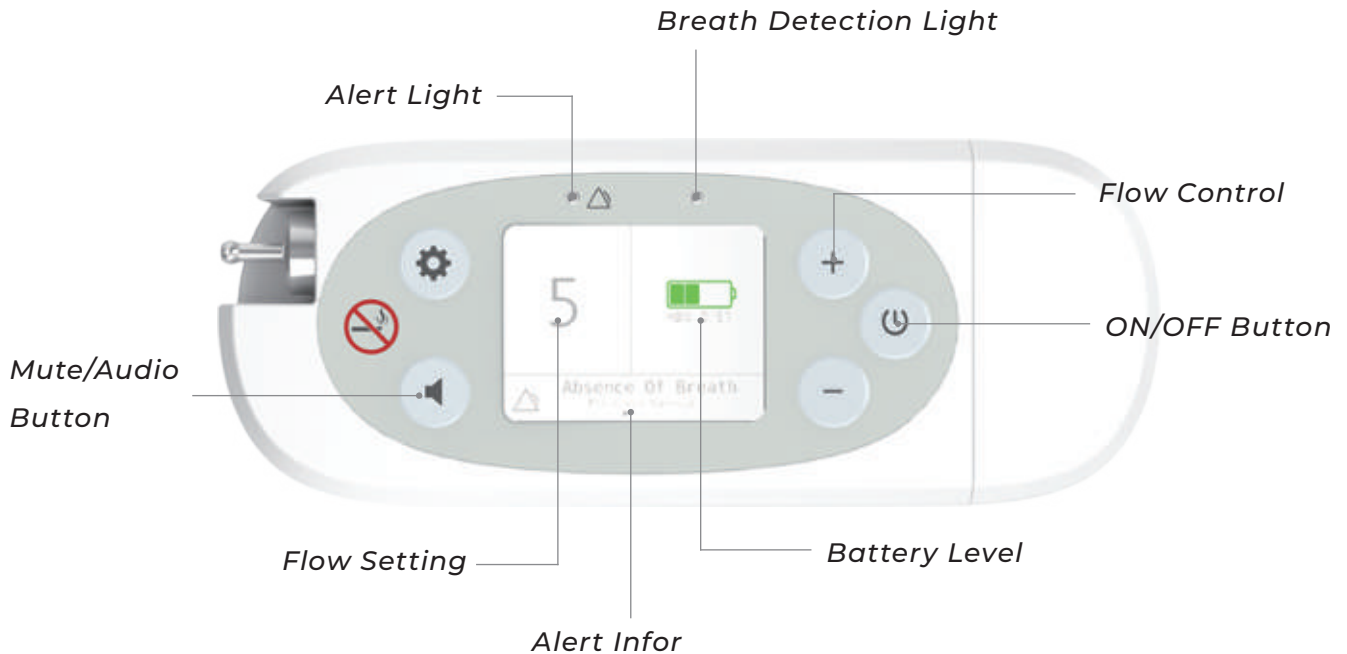

# Accessories

**Standard package:** Carry Bag 、 Nasal Cannula 、 Battery 、 AC Adapter 、 Filter

**Optional Accessories:** External battery charger 、 Backpack 、 Sieve bed



# Product Specification

<i>Oxygen Concentration</i>	<i>90%-3%/+6% at all settings</i>
<i>Oxygen Flow Max</i>	<i>1 Liter/min, equivalent to 5 Liters</i>
<i>Warm-Up Time</i>	<i>2 minutes</i>
<i>Weight</i>	<i>4.37 lbs. 1.98kg ( includes battery)</i>
<i>Size</i>	<i>Length: 8.70" ( 221mm ) Width:6.30" (160mm ) Height: 3.35" ( 85mm ) (includes battery)</i>
<i>Oxygen Flow</i>	<i>Pulse dose delivery system Five flow settings 1, 2, 3, 4, 5</i>
<i>Power</i>	<i>AC Power Supply 100-240V, 50-60Hz (auto sensing to allow worldwide use) Voltage: 14.4VDC Rated capacity:6.8Ah</i>
<i>Battery</i>	<i>Duration : Up to 5 hours Recharge approximately 4 hours with AC power DC power</i>
<i>Noise Level</i>	<i>49 Decibels*@setting 2</i>
<i>Display Screen</i>	<i>2.8 inch</i>
<i>Warranty</i>	<i>3 year of warranty(Excluding Battery &amp; Sieve Bed)</i>
<i>Operation</i>	<i>Simple control functions and easy-to-read LCD display</i>
<i>Use</i>	<i>Designed for 24/7 use</i>



# About Kingon

*Qingdao Kingon Medical Science and Technology Co.,Ltd,  
has been concentrating on the research and development of portable oxygen concentrator for 5 years.*

*With powerful research and development team,a first-class laboratory equipment and abundant capital,Kingon has produced a portable oxygen concentrator-- P2, it is the smallest and lightest in the world of 1L-Oxygen Concentrator.*

*Kingon,based on the principles of" Breathe Free Walk With YOU",focus on customer needs,offer patients a helpful oxygen therapy and enhance their life quality.*

*In the future,we will be still in technically constant innovation,improve the quality of the products and service,the expectation and demand that are devoted to content with our client.Kingon is energetic and creative.We are based on the domestic market,and actively explore global business We are willing to cooperate with distributors from all over the world,accept multiple ways of cooperation,ODM,OEM.*

*We look forward to cooperating with you!*

# kingon

*Qingdao Kingon Medical Science and Technology Co., Ltd*

*Manufacturer Address :*

*Room 301-302, No. 15 Hancheng Road ,  
Qingdao Free Trade Zone, Shandong , China, 266555*

*Factory Address:*

*24 th Factory Building, NO. 252 Yanhe Road,  
Huangdao, Qingdao, Shandong, China, 266510*

*E-mail: [kingonmed@gmail.com](mailto:kingonmed@gmail.com)*

*Tel: 0086 532 86767095 // 0086 532 58792324*

*[www.kingonmed.com](http://www.kingonmed.com)*

